

Parts list for the **BARK MARK™** Timber Marking Paint System 4-gallon Backpack Sprayer

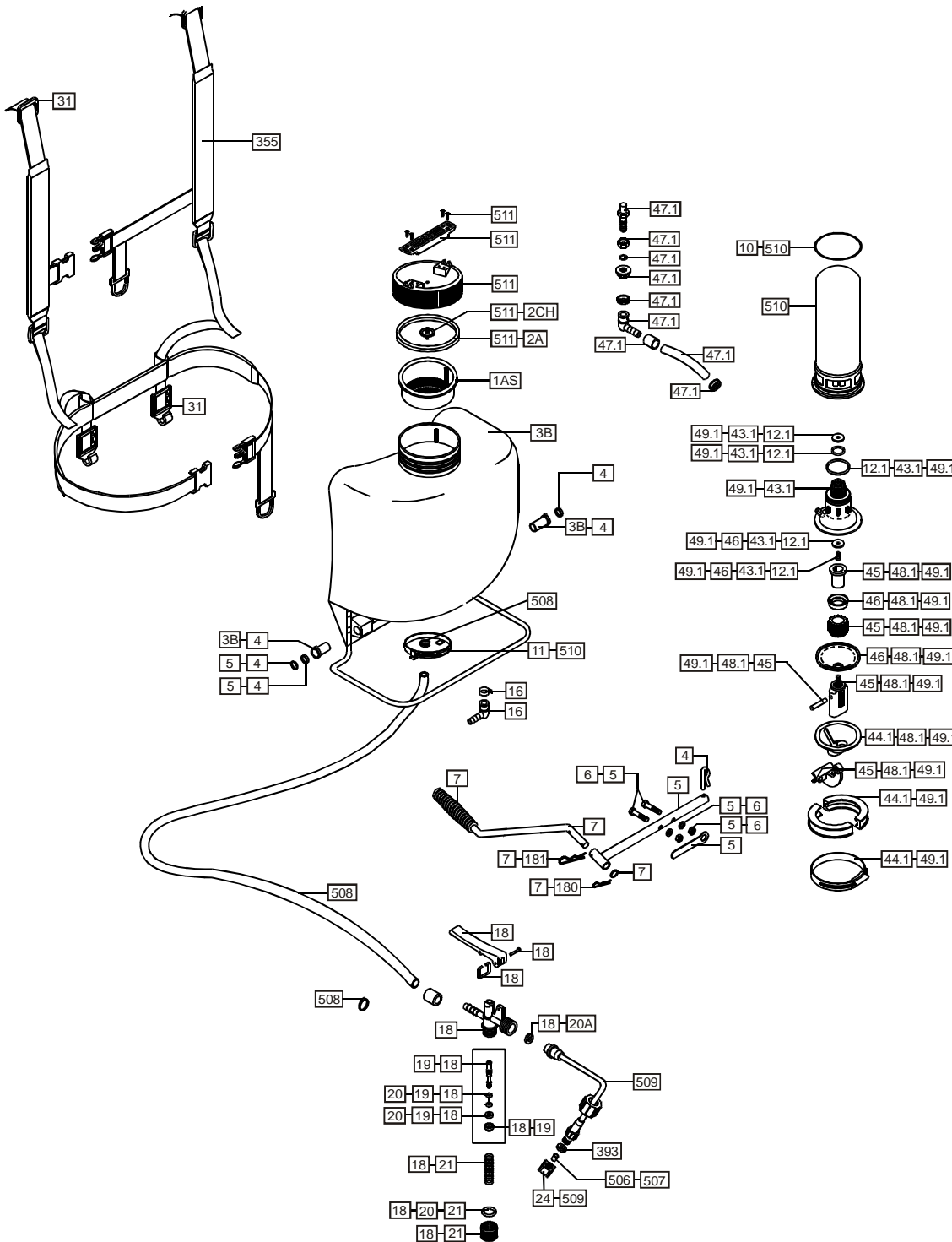

PARTS LIST

- 1AS Seal for cap 6".
- 2A Strainer with venting hole.
- 2CH Check valve for cap.
- 3B Tank with reset strap attachments.
- 4 Nylon bearing.
- 5 Pump lever (fold-back-type).
- 6 Screw and nut set.
- 7 Pump handle (fold-back-type).
- 10 Pressure tank "O" ring.
- 11 Retention clamp.
- 12.1 "O" ring & washer set diaphragm-piston.
- 16 90 degree fitting.
- 18 Complete spray pistol.
- 19 Spindle set.
- 20 Spindle "O" ring set.
- 20A Rubber washer.
- 21 Plug set.
- 24 Nozzle nut.
- 31 Belt hooks.
- 43.1 Complete cylinder assembly new sealing.
- 44.1 Diaphragm protector, half moon jaws & clamp.
- 45 Piston pump holder & guide.
- 46 Diaphragm plastic piston & internal seal.
- 47.1 Agitating hose, clamps & tank connector.
- 48.1 Complete piston diaphragm assembly.
- 49.1 Complete pump module.
- 180 Locking pin-pump handle (small).
- 181 Locking pin-pump handle (large).
- 355 Harness.
- 393 Rubber washer.
- 506 Tip (pink).
- 507 Tip (orange).
- 508 Oil resistant hose with clamp.
- 509 Brass spray wand.
- 510 Special solvent resistant pressure chamber.
- 511 Green lid 6" with handle.



Timber Marking Paint System

1-800-627-1948

NCPCoatings.com

NOTE:

For best results, the sprayer should be pumped every 5 seconds on a continuous basis. This will maintain your spraying pressure. If you do not pump, you will not have pressure to spray.

The BARK MARK™ Timber Marking Paint System

We would like to congratulate you on the purchase of your new BARK MARK™ Timber Marking Paint System. The sprayer that allows you the easiest, most comfortable way of carrying out your Timber Marking needs with the revolutionary piston-diaphragm pump (patented), that all but eliminates the problems inherent in most sprayers.

As a new owner of the skillfully engineered BARK MARK™ Timber Marking Paint System, we strongly recommend you carefully read and follow all the information on this sheet before use, and then save for future reference.

Please read the attached trouble shooting guide.

HOW TO ASSEMBLE

1. Attach spray wand to spray gun and tighten firmly.
2. Take pump handle 7 and insert into the tube on the pump lever 5 (Z shape lever on sprayer), you will notice holes drilled through both sides of both the pump handle and the pump lever. Align these holes, take the "R" pin provided and place through the holes. This affixes the handle in place and is ready for use.
For storage reverse process and then place "R" pin through the pump lever 5 to keep from losing "R" pin.
3. Instructions for installing shoulder strap plastic buckle:
First put the sprayer on a hard flat surface, take the white plastic buckle and while holding the sprayer up slightly, place buckle under the tubular metal frame. Slowly push down forcing the frame into the buckle. Repeat same procedure for other side.

HOW TO PREPARE YOUR UNIT FOR USE

1. Remove cap.
2. Mix solution in a separate receptacle, following manufacturers directions on the container.
3. Pour pre-mixed solutions into sprayer and cap.
4. Place sprayer on back and pressurize tank by pumping approximately 10 to 15 times. **For best results, the sprayer should be pumped every 5 seconds on a continuous basis. This will maintain your spraying pressure. If you do not pump, you will not have pressure to spray.**
5. Always oil the seal on cap of unit as well as the check valve, this will extend life of seal and is important for obtaining proper seal with no leaks.

HOW TO CLEAN AND MAINTAIN

1. Remove cap and pour out remaining solution, then rinse all parts thoroughly with clean water. If using solvent based paint, first clean with the solvent recommended by the paint manufacturer.
2. Leaving approximately 1/2 gallon of fresh water in tank, pressurize and flush pumping system by depressing trigger at least 2 minutes, then drain all remaining water.
3. If using a solvent to first clean the sprayer (applicator), then use 1/2 gallon of clean water and mix in a mild soap, (like dishwashing soap, Palmolive) to neutralize the solvent. Then follow the same instructions on #2 and #4.
4. Always store tank clean and empty in a dry, shaded location.

CAUTIONS

Failure to follow manufacturers recommendation on use and care of unit will void any expressed or implied warranty.

Do not use chlorine or clorox. It will permanently damage pump system.

Please read and follow all instructions before using sprayer.

- Before using, filling or cleaning any sprayer, read all parts of the operating instructions.
 - Make sure to set up the sprayer exactly as explained in the printed operating instructions, reminder tags and/or stickers.
 - Wear protective clothing, respirator, gloves, eye protection, etc. whenever using, filling, or cleaning sprayer.
 - Periodically re-grease lid gasket as well as lid vent and pump cylinder, where applicable.
 - To ensure good performance, keep lid vent free of obstruction. Before and after each use, make sure all connections are well tightened. Service and replace worn parts as required.
 - Read and follow all instructions of the paint suppliers.
 - As a rule, mix your chemicals in a separate container from which to fill the sprayer. Do not mix formulas inside the sprayer. Where an exception is made fill sprayer with water BEFORE adding the active ingredient.
 - Always sift formula through the screen. If there is no built-in strainer, use a screened funnel.
 - Never fill the sprayer with hot liquids. Max. 30°C, or 85°F.
 - This sprayer is made to handle paints from NCP Coatings in their usual water or oil solutions. Do not use flammable, corrosive or caustic solutions.
 - Never use gasoline or other flammable materials.
 - Before cleaning or servicing the sprayer, allow all pressure to escape. Do not store or transport sprayer under pressure.
 - After each use, wash the sprayer—including hose, lance and shut-off valve—with plenty of fresh water. Unless spraying is to be continued within hours, drain chemical formula and thoroughly rinse the tank and all liquid ducts.
 - Never store chemicals in your sprayer for any length of time.
 - Use the sprayer only for the kind of jobs for which it was designed. When in doubt, ask your dealer.
 - Do not leave the sprayer in reach of children or persons not qualified to handle it in proper fashion.
 - When not in use—and especially during prolonged storage—keep your sprayer in a protected place away from direct solar heat.
 - Make sure the spray hose loops freely without kinking or squeezing.
- Always use original replacement parts.

BN513.025-0505E/EX
Rev.02